

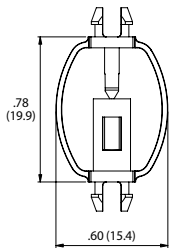

LOCKING CIRCUIT BOARD SUPPORTS

CBSP
PCB Spring Spacer



As Molded

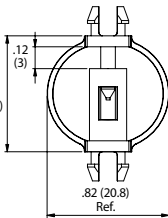

Assembled

Top Hole:
Snap-lock: .189 (4.8)
Panel Thickness:
.062 (1.57)

Bottom Hole:
Snap-lock: .189 (4.8)
Panel Thickness:
.062 (1.57)

- When pin is inserted into spacer, part flexes and acts as a plastic spring
- One piece design reduces the need for hardware
- Provides continuous support to PCB
- Keeps light sensors on the PCB in constant contact with touch control cover
- Material: Acetal
- Color: Natural
- Flame Class: UL94 HB

Item No.	Bulk Pack Qty
CBSP-1	1000

CBSPM
Rubber Pull Mount Circuit Board Support

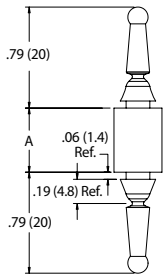

Top Hole:
Snap-fit: .187 (4.75)
Panel Thickness:
.094 (2.4) Max

Bottom Hole:
Snap-fit: .187 (4.75)
Panel Thickness:
.094 (2.4) Max

- Rubber spacer provides shock and vibration protection
- Pull mount ends are easily fed into panel holes and pulled into a locked position
- Once installed, the ends are easily cut off leaving low profile mounting ends
- Material: EPDM, 45 Shore A
- Color: Black

Item No.	A		Bulk Pack Qty.
	In	mm	
CBSPM-4	.250	6.35	500
CBSPM-6	.375	9.53	500
CBSPM-8	.500	12.70	500
CBSPM-10	.625	15.88	500
CBSPM-12	.750	19.05	500

LCBS Series
Locking Support



Specifications:

- Material: Nylon 6/6
- Color: Natural

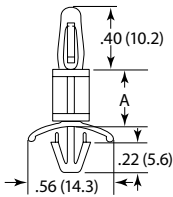

To Lock in Hole:
.156 (4)
Panel Thickness:
.047-.067 (1.2-1.7)

To Lock in Hole:
.187 (4.8)
Panel Thickness:
.031-.078 (0.8-2.0)

Item No.		A		Bulk Pack Qty.
		In	mm	
UL94 V-2	UL94 V-0	In	mm	1000
CBLS005A	—	0.138	3.5	
LCBS-3-01	LCBS-3-19	0.187	4.8	1000
LCBS-6M-01	LCBS-6M-19	0.236	6.0	1000
LCBS-4-01	LCBS-4-19	0.250	6.4	1000
LCBS-5-01	LCBS-5-19	0.312	7.9	1000
LCBS-6-01	LCBS-6-19	0.375	9.5	1000
LCBS-7-01	LCBS-7-19	0.437	11.1	1000
LCBS-8-01	LCBS-8-19	0.500	12.7	1000
LCBS-10-01	LCBS-10-19	0.625	15.9	1000

Item No.		A		Bulk Pack Qty.
		In	mm	
UL94 V-2	UL94 V-0	In	mm	1000
LCBS-12-01	LCBS-12-19	0.750	19.1	
LCBS-14-01	LCBS-14-19	0.875	22.2	1000
CBLS060A	—	0.945	24.0	1000
LCBS-16-01	LCBS-16-19	1.000	25.4	1000
LCBS-18-01	LCBS-18-19	1.125	28.6	1000
CBLS075A	—	1.224	31.1	1000
LCBS-20-01	LCBS-20-19	1.250	31.7	1000
LCBS-22-01	LCBS-22-19	1.375	34.9	1000

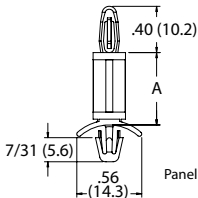

Top Hole:
Snap-lock: .156 (4.0)
Panel Thickness: .062 (1.57)

Bottom Hole:
Snap-lock: .187 (4.8)
Panel Thickness: .031 - .078 (.79 - 1.98)

Item No.		A		Bulk Pack Qty.
		In	mm	
UL94 V-2	UL94 V-0	In	mm	1000
LCBS-2-3-01	LCBS-2-3-19	.0188	4.8	
LCBS-2-4-01	LCBS-2-4-19	.0250	6.4	1000
LCBS-2-5-01	LCBS-2-5-19	0.313	7.9	1000
LCBS-2-6-01	LCBS-2-6-19	0.375	9.5	1000
LCBS-2-7-01	LCBS-2-7-19	0.438	11.1	1000
LCBS-2-8-01	LCBS-2-8-19	0.500	12.7	1000
LCBS-2-10-01	LCBS-2-10-19	0.625	15.9	1000

Item No.		A		Bulk Pack Qty.
		In	mm	
UL94 V-2	UL94 V-0	In	mm	1000
LCBS-2-12-01	LCBS-2-12-19	0.750	19.1	
LCBS-2-14-01	LCBS-2-14-19	0.875	22.2	1000
LCBS-2-16-01	LCBS-2-16-19	1.000	25.4	1000
LCBS-2-18-01	LCBS-2-18-19	1.125	28.6	1000
LCBS-2-20-01	LCBS-2-20-19	1.250	31.8	1000
LCBS-2-22-01	LCBS-2-22-19	1.375	39.9	1000

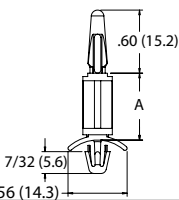

Top Hole:
Snap-fit: .156 (4.0)
Panel Thickness: .062 (1.57)

Bottom Hole:
Snap-lock: .187 (4.8)
Panel Thickness: .031 - .078 (0.8 - 2.0)

Item No.		A		Bulk Pack Qty.
		In	mm	
LNCBS-3-01	—	0.188	4.8	1000
LNCBS-4-01	—	0.250	6.4	1000
LNCBS-6-01	—	0.375	9.5	1000
LNCBS-8-01	—	0.500	12.7	1000

Item No.		A		Bulk Pack Qty.
		In	mm	
LNCBS-10-01	—	0.625	15.9	1000
LNCBS-12-01	—	0.750	19.1	1000
LNCBS-14-01	—	0.875	22.2	1000

- Long "nose" automatically locates and aligns connector pins with socket